

0514 SERIES



Pitch: 1.27mm(0.05") For 0.46 Square Pin, Female Header, Single Row, Straight

Specifications

Current Rating: 1Ampere
 Insulation Resistance: 500MΩ Min.
 Dielectric Withstanding: 300V AC
 Contact Resistance: 20mΩ Max.
 Operating Temperature: -40°C to +105°C

Materials

Contact Material: Phosphor Bronze
 Contact Plating: Gold/Tin over Nickel
 Insulator: Glass Filled Polyester (UL 94V-0)

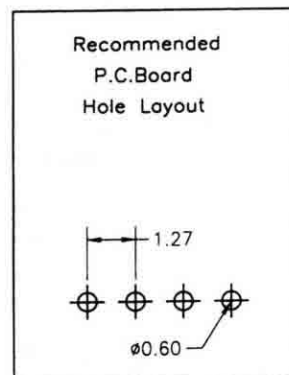
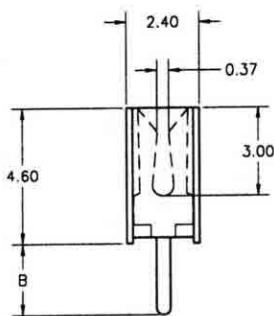
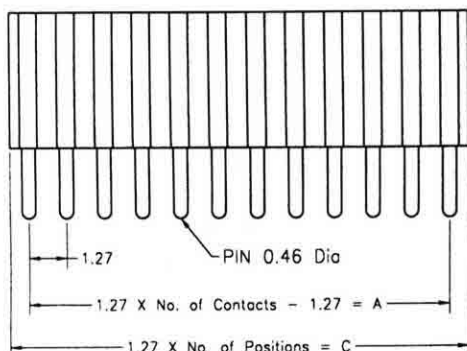
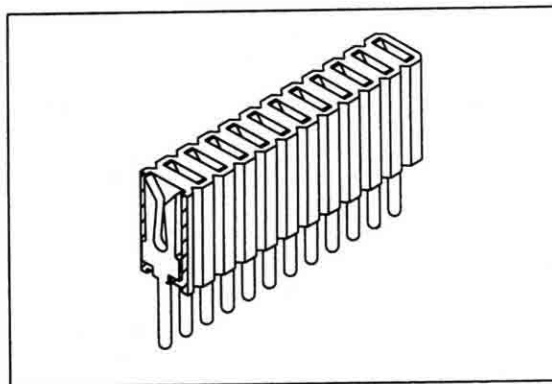

No. of Pins/Row	Dimension Information		No. of Pins/Row	Dimension Information		No. of Pins/Row	Dimension Information		No. of Pins/Row	Dimension Information	
	A	C		A	C		A	C		A	C
03	2.54	3.81	13	15.24	16.51	23	27.94	29.21	33	40.64	41.91
04	3.81	5.08	14	16.51	17.78	24	29.21	30.48	34	41.91	43.18
05	5.08	6.35	15	17.78	19.05	25	30.48	31.75	35	43.18	44.45
06	6.35	7.62	16	19.05	20.32	26	31.75	33.02	36	44.45	45.72
07	7.62	8.89	17	20.32	21.59	27	33.02	34.29	37	45.72	46.99
08	8.89	10.16	18	21.59	22.86	28	34.29	35.56	38	46.99	48.26
09	10.16	11.43	19	22.86	24.13	29	35.56	36.83	39	48.26	49.53
10	11.43	12.70	20	24.13	25.40	30	36.83	38.10	40	49.53	50.80
11	12.70	13.97	21	25.40	26.67	31	38.10	39.37			
12	13.97	15.24	22	26.67	27.94	32	39.37	40.64			

Ordering Information

0514 - X X X - X X 0

1: Tin 00: B=2.4mm Position

2: Gold 01: B=1.5mm

4: 10U" Gold

5: 30U" Gold